

YZS-102 双针压力表

YZS-102 series double pointer double pipe pressure gauge

用途说明 Application Description

双针压力表主要适用于机车车辆上测量液压系统或储气缸内的压力，亦可同时测量对铜合金及锡铅合金纤料无腐蚀性、非结晶和非凝固介质的两个相同或不相同的压力。

This gauge mainly used in measuring the pressure of the liquid pressure system or the gas jar on the engine, also can measure two same pressure or two different pressure of the service medium at the same time which have none-corrosion, non-crystallized, non-solidified whih copper alloys, plumbum-stin alloys welding materials.

结构原理 Structure

仪表由两套各自独立的测量系统和指示装置组成。被测压力作用于两测压元件(弹簧管)后致使管端各自产生相应的位移，经传动机构放大后，由固定在齿轮轴上的红、黑指针逐将两个被测压力值分别在度盘上指示出来。

This gauge is made up of two autocephaly measuring and pointingsystem.The gauges work base on flexibility parts(the flexibility tube in the measuring system) characteris change.It's means that,the media's pressure make the tube moving, with the stick and gear help. Sending and making it bigger, then the pointer point it out on the dial.

主要技术指标 Main Technical Data

- ◇ 精确度等级：1.6。
- ◇ 标度范围：0~1000;1200;1600;2500KPa。
- ◇ 使用环境条件：5~60℃，相对湿度不大于80%。
- ◇ 温度影响：不大于0.4%/10℃(使用温度偏离20±5℃)。
- ◇ 重量：0.7kg。
- ◇ Accuracy class:1.6.
- ◇ Scale range:0-1000;1200;1600;2500KPa.
- ◇ Environmental condition:5℃~60℃, relative humidity is no more than 80%.
- ◇ Temperature effect: when environmental temperature deviates from 20 ± 5℃,additional error is no more than 0.4%/10℃.
- ◇ Weight:0.7kg.

外形尺寸 Dimension

单位(Unit): mm



YZS-102

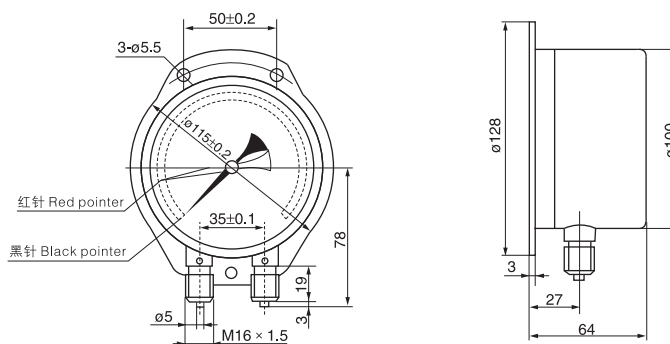

YT 系列特种压力表

YT series special type pressure gauge

YTS-100、150耐酸压力表

YTS-100,150 acidproof pressure gauge

YTF、YTH耐腐耐高温压力表

YTF,YTH anti-corrosion high temperature resistance pressure gauge.

YTU-100S、150S耐硫压力表

YTU-100S、150S anti-sulfur pressure gauge



YTH-100



YTS-100



YTU-100S

用途说明 Application Description

特种压力表适用各工业部门生产工艺流程中对测压仪表有特殊要求的场合。耐酸压力表的全部零件，采用不锈钢材料制成。具有较强的耐腐蚀性能，适用于检测腐蚀性较强介质的压力和在外部的腐蚀环境中使用。广泛应用于石油、化工、农药等工业企业。

耐腐耐高温压力表的全部零件均用不锈钢材料制成，导压系统采用特殊焊接工艺。具有优良的耐腐蚀性能，适用于对腐蚀性较强的介质和锡钎焊工艺不宜采用的高温介质或温度较高环境中的压力检测。广泛应用于石油、化工、农药、橡胶等企业。

耐硫压力表的测压系统采用具有抗硫性能的特种不锈钢材料制成。适用于对硫化氢天然气等介质的压力测量。在石油、天然气、化工、化纤等企业得到广泛的应用。

The special kind of the pressure gauge is suited for the situation which is strict to the measuring gauge in the manufacture. the whole accessory of the acid-proof pressure gauge adapted the stainless steel materials. and have the high anti-corrosive performance. So it is suited for measuring the pressure of the service medium which is high corrosive and being used in the badly corrosive environment this gauge is widely used in the oil industry, chemical industry, and pesticide enterprise.

The whole accessory of anti-corrosive, high temperature resistance pressure gauge is made by the stainless steel materials, inducing pressure system adopt special welding crafts. So this gauge have excellent anti-corrosive performance, suited for measuring the pressure of the medium which is high corrosive or the pressure of the medium which should not be adopted in the solder welding.

The measuring pressure system of the anti-sulfur pressure gauge adapt the specially anti-corrosive stainless steel materials. This gauge is suited for measuring the pressure of the sulfureted hydrogen and natural gas and is widely used in the oil industry, natural gas industry, chemical industry and chemical fibre industry.

主要技术指标 Main Technical Data

◇ 标度范围及精确度等级 Scale range and accuracy class

型号 Model	标度范围(MPa) Scale range	精确度等级 Accuracy
YTS-100	0~0.1;0~0.16;0~0.25;0~0.4;0~0.6; 0~1;0~1.6;0~2.5;0~4;0~6;0~10; 0~16;0~25;0~40;0~60; -0.1~0;-0.1~0.06;-0.1~0.15; -0.1~0.3;-0.1~0.5;-0.1~0.9; -0.1~1.5;-0.1~2.4	1.6
YTS-150		
YTU-100S		
YTU-150S		
YTF YFH		

◇ 使用环境条件: -40~70℃

-40~200℃, (YTH型)

相对湿度不大于85%

◇ 温度影响: 使用温度偏离20±5℃时, 其温度附加误差不大于0.4%/10℃。

- ◇ Environmental condition: -40℃~70℃
-40℃~200℃(YTH type)
relative humidity is no more than 85%.
- ◇ Temperature effect: when environmental temperature deviates from 20 ± 5℃,additional error is no more than 0.4%/10℃.

外形尺寸 Dimensions

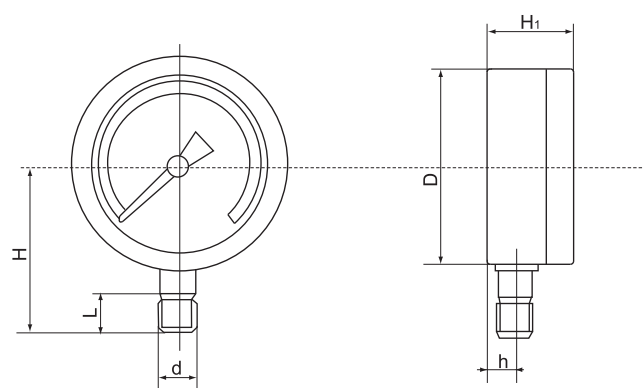

单位(Unit): mm

型号 Model	D	H	L	d	h	H ₁
YTS-100 YTU-100S YTH-100	Φ 100	90	20	M20×1.5	21	50
YTS-150 YTU-150S YTF-150	Φ 150	115	20	M20×1.5	21	50

YQS、YQSN 不充液/充液系列工业过程(酚醛壳)安全系列压力表

Industrial process(phenolic aldehyde) safety series pressure gauge Mode YQS/YQSN, no liquid-filling/liquid filling

产品概述 Product Overview

此仪表广泛应用于石油、化工、食品、饮料、制冷等生产过程中，被测介质及环境条件对仪表要求都非常苛刻的地方使用。

本仪表具有坚固的带有安全隔板的卸压后盖的外壳。

This gauge is widely used in production process of oil industry, chemical industry, food, drink and refrigeration, etc. It is suitable for measured media and environment condition which have a high demand on gauges.

This gauge has a solid pressure relief cover with safety clapboard



YQS-150

规格选型 Optional specifications

① — ② ③ ④ ⑤ ⑥



①	基本型号 Basic type
YQS	标准型工业过程安全压力表 Standard industrial process safety pressure gauge
YQSN	耐震型安全压力表 Shake resistance safety pressure gauge
YQSF	不锈钢防腐型安全压力表 Stainless steel anticorrosive safety pressure gauge
YQSFN	不锈钢防腐耐震型安全压力表 Stainless steel anticorrosive shake resistance safety pressure gauge
②	外径 Diameter
150	φ 150mm
③	安装方式 Mounting pattern
无标注 No label	径向直接安装 Low mount
Z	偏心轴向安装 Low back mount

④	量程 Scale range
	-0.1~0~-0.1~2.4MPa, 0~0.1~0~60MPa
⑤	连接螺纹 Connection thread
M20	20 × 1.5
Z12	NPT1/2
T00	特殊螺纹 Special connection
⑥	附加项 Additional items
SBD	安全双层玻璃 Safety double-layer glass
SBB	有机玻璃 Organic glass
SYF	充氟油 fluorocarbon oil filling
FWP	带不锈钢位号 With stainless steel items
F	配隔膜体、过压保护器、散热器 With diaphragm body, over-pressure protection, radiator

技术参数 Technical parameters

- ◇ 执行标准：GB/T1226-2001
- ◇ 仪表直径：φ 150(mm)
- ◇ 精度等级：1.6%(可选1%)
- ◇ 测量范围：-0.1~0~-0.1~2.4MPa，0~0.1~0~60MPa
- ◇ 防护等级：IP65
- ◇ 工作环境温度：-20~60℃
- ◇ 工作介质温度：≤100℃，但精度受温度影响，温度每变化40℃，精度变化1.5%。
- ◇ 仪表外壳：酚醛壳(聚丙烯)黑色带有安全隔爆层和安全卸压后盖表壳，可做后带边直接固定。
- ◇ 卸压片：耐油橡胶
- ◇ 充油塞：耐油橡胶
- ◇ 仪表接头：SUS304(可选SUS316)
- ◇ 波登管：铜合金、SUS316
- ◇ 管接头焊接方式：锡焊、银焊、氩弧焊
- ◇ 仪表机芯：SUS304
- ◇ 仪表玻璃：有机玻璃(可选防爆双层安全玻璃)
- ◇ 表针：调零表针 黑色 铝
- ◇ 表盘：铝 白底黑刻度字 MPa(可选bar/psi.....)
- ◇ 连接方式：M20×1.5或约定的特殊要求

- ◇ Executive standard: GB/T1226-2001
- ◇ Diameter: ϕ 150(mm)
- ◇ Accuracy class: 1.6%(or 1%)
- ◇ Scale range: -0.1-0~-0.1-2.4MPa, 0-0.1-0-60MPa
- ◇ Ingress protection: IP65
- ◇ Working temperature: -20~60°C
- ◇ Medium temperature: $\leq 100^{\circ}\text{C}$, accuracy class is influenced by temperature, every time temperature changes 40°C , accuracy class changes by 1.5%
- ◇ Case: phenolic aldehyde case(polypropylene), black with safety explosion-proof layer and safety pressure relief cover. The case can be added with flange and directly fixed.
- ◇ Liquid-filled plug: oil-resisting rubber
- ◇ Oil-filling plug: oil-resisting rubber
- ◇ Connect of the gauge: SUS304(or SUS316)
- ◇ Bourbon tube: copper alloy, SUS316
- ◇ Connection solder: soldering, silver soldering, argon shielded arc welding
- ◇ Movement: SUS304
- ◇ Gauge glass: organic glass(or explosion-proof double-layer safety glass)
- ◇ Pointer: zero-setting indicator, black aluminum.
- ◇ Dial: white aluminum, black lettering MPa(or bar/psi...)
- ◇ Connection: M20*1.5 or special types

工作压力及使用范围 Working pressure and scope of application

- | | |
|---------------|-------------------------------------|
| ◇ 静压: 3/4X满量程 | ◇ Static pressure : 3/4* full range |
| ◇ 动压: 2/3X满量程 | ◇ Dynamic pressure: 2/3* full range |
| ◇ 瞬时: 1.3X满量程 | ◇ Instant pressure: 1.3* full range |

外形尺寸 Dimensions

